

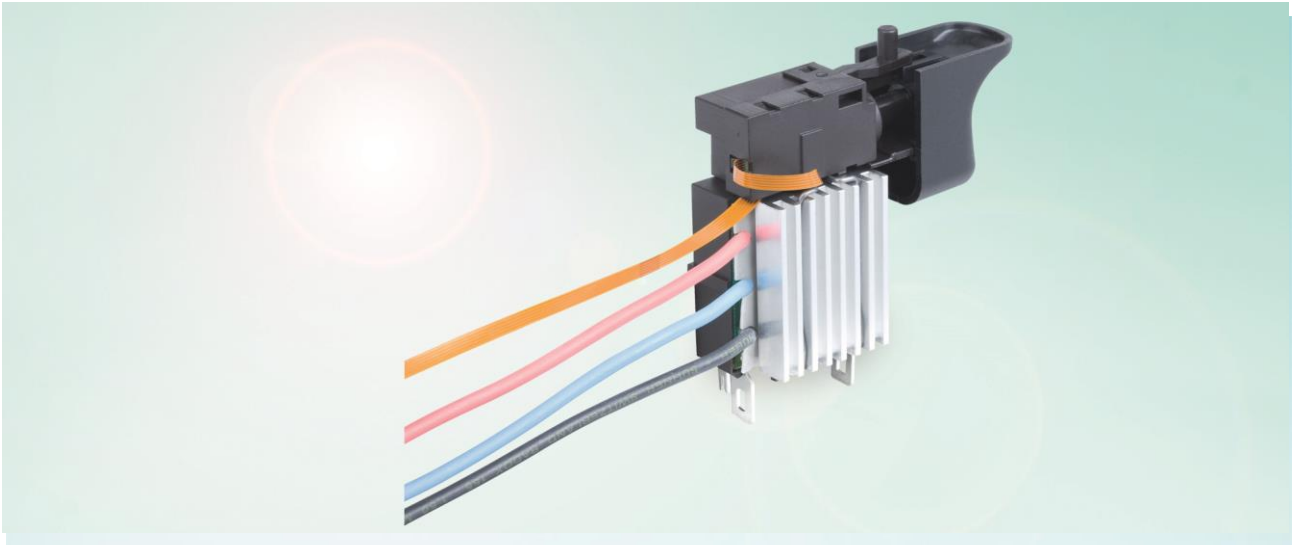

# SERIES 2800 – EC MOTOR CONTROL



## ADVANTAGE

**Compact design for professional usage in challenging and harsh environment**

**Easy assembly**

**High quality**

**High level of reliability**

**Numerous versions**

## PRODUCT FEATURES

- Compact switch with integrated EC control for DC power tools with brushless motors
- Highly integrated control with easy assembly in existing systems
- Maximum power density, efficiency up to 95 %
- Increased battery endurance, optimized balancing of electronics and motor
- Different versions available e.g. feedback control, motor brake current and voltage monitoring

## EXAMPLES OF APPLICATION

- Cordless drill /drill drivers
- Cordless impact drivers
- Cordless industrial screwdrivers
- Electrical vehicles
- Household appliances
- Laboratory equipment
- Industrial applications

Battery nominal voltage	12 V – 18 V 18 V – 24 V 24 V – 36 V
Mechanical life	2E6
Detection of rotor position	Hall sensors, optional sensorless
Stall current	Max. 100 A for approx. 5 s
Continuous current	
→ Without ventilation	15 A (18 V)
→ With air flow > 2m/s	25 A (18 V)
Terminal type	
→ Battery	Solder terminals
→ Motor	3 wires
→ Sensors	Flex cable
Additional electronic functions	Reversing of rotation Current monitoring Voltage control Temperature control Serial data interface
Approval marks (UL)	UL (will be applied for)



# SERIES 2800 – EC MOTOR CONTROL

## DRAWINGS

(Dimensions in mm)

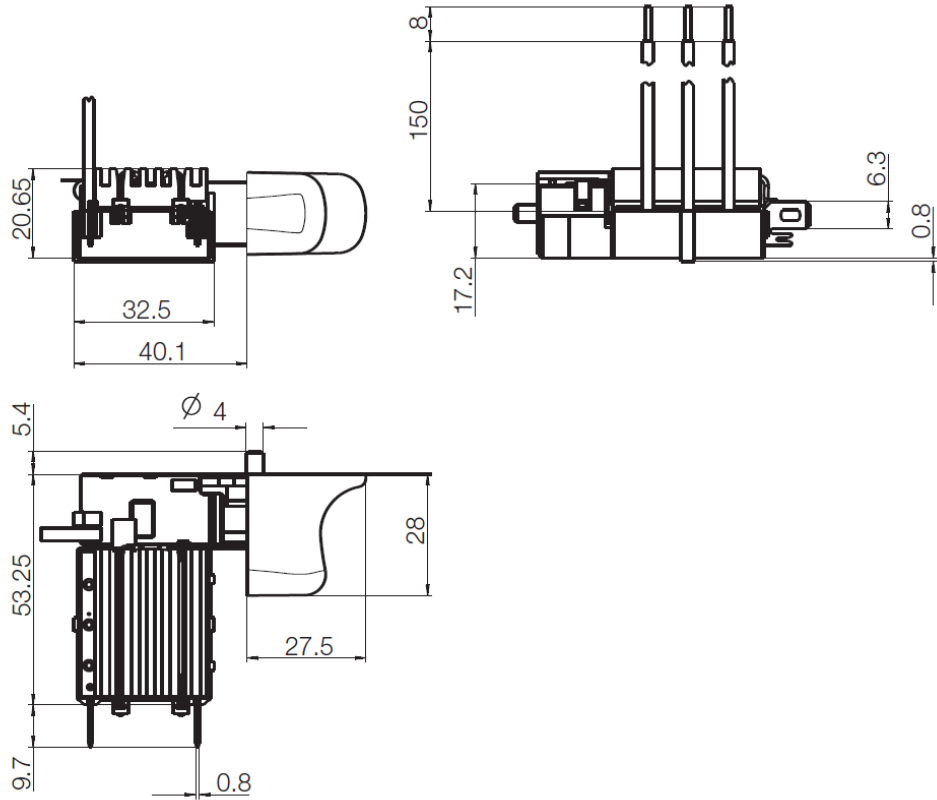

## CIRCUIT

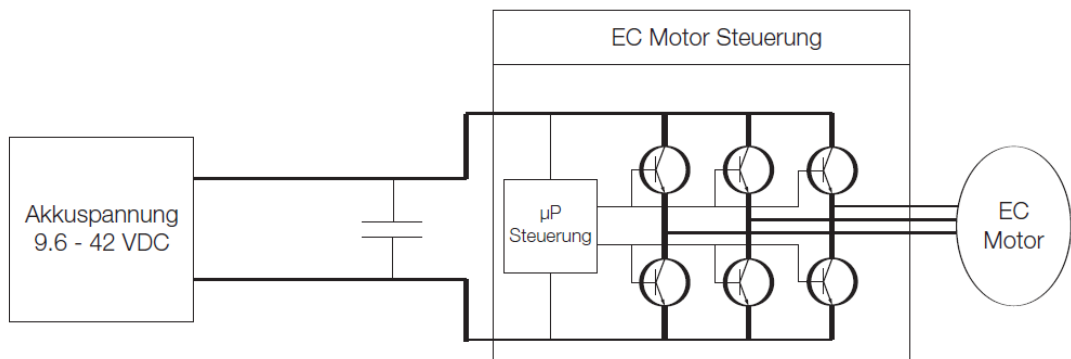

**MARQUARDT**

Marquardt Verwaltungs-GmbH · Ernst-Müller-Str. 7 · 8201 Schaffhausen · Switzerland  
Phone +41 (52) 644 30 00 · Fax +41 (52) 644 30 60 · info@marquardt.ch · www.marquardt.ch