

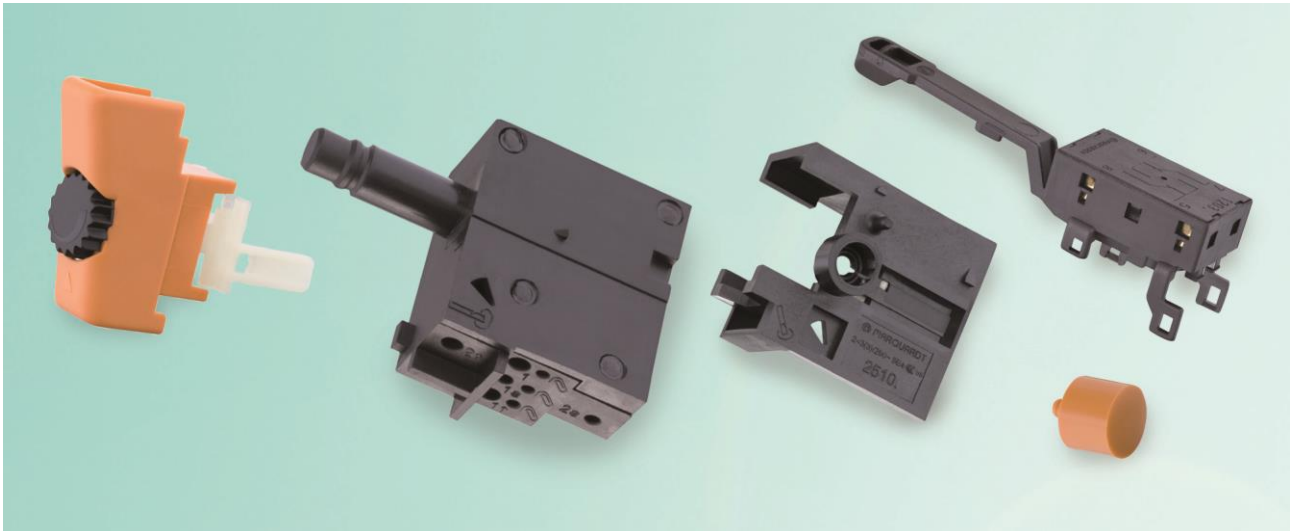

SERIES 2510 – ELECTRONIC SPEED CONTROL SWITCH



ADVANTAGE

Modular solution

Compact design

Wide rating range

Easy assembly

High flexibility

Numerous versions

Excellent price-performance ratio

PRODUCT FEATURES

- Basic module as complete AC variable speed control
- Small, very compact dimensions
- For appliances up to approx. 700 W at 230 V ~ respectively approx. 500 W at 125 V AC
- Simple connection through push-in terminals
- Easily extendable with by means of outer frames; extensible with customized frame, with integration of capacitor and other customized anti-interference measurement
- Different reversing switches and actuators (with / without thumb wheel), direct and indirect actuating possible
- Low cost switch for medium specified applications

EXAMPLES OF APPLICATION

- Drills
- Percussion drills
- Jig saws
- Other applications

Rating	2 < 3 (3) A 250 V AC 6 A 125 V AC (contact system)
→ Half-wave speed control	250 V version up to 700 W applications
→ Half-wave speed control	125 V version up to 500 W applications
Life endurance	
→ Electrical	5E4
→ Mechanical	5E4
Switching function	Single-pole with by-pass contact (half-wave speed control)
Trigger travel	
→ Total trigger travel	Approx. 8 mm
→ Operating position	Approx. 2 mm
→ By-pass position	Approx. 6 mm
Terminals	
→ Main side	Push-in terminal for optional capacitor
→ Motor side	Push-in wires 1mm ² , tinned
Approval marks	
Suitable for appliances of protection class II	



SERIES 2510 – ELECTRONIC SPEED CONTROL SWITCH

DRAWINGS

(Dimensions in mm)

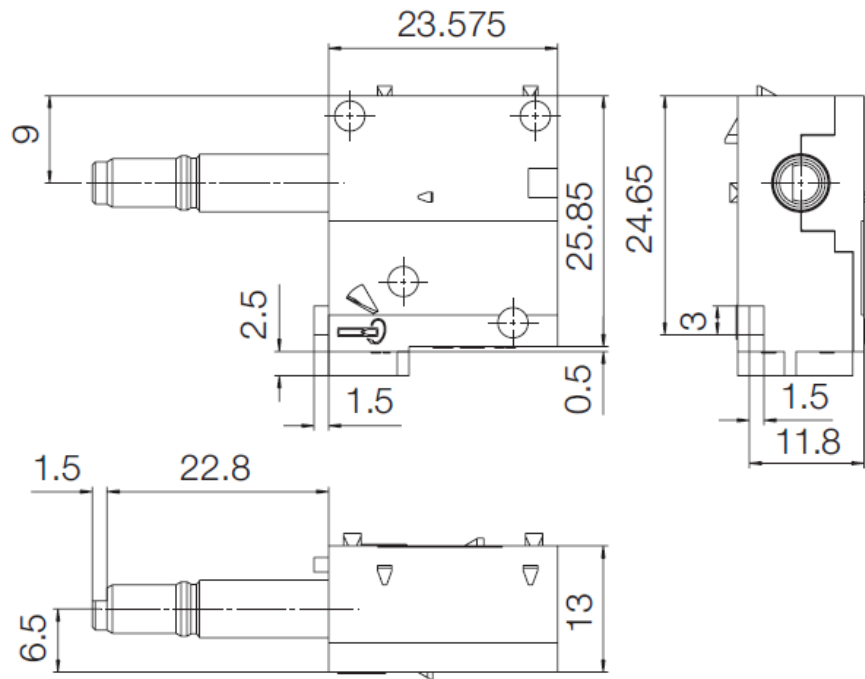

CIRCUIT

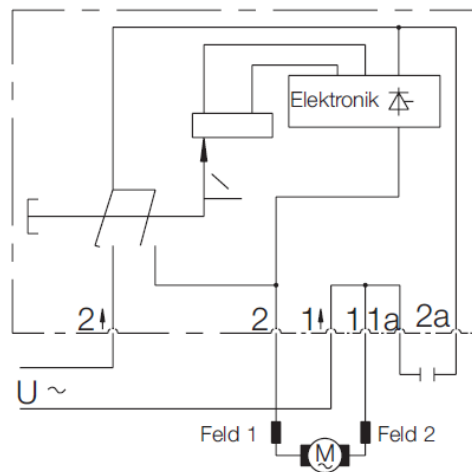

MARQUARDT

Marquardt Verwaltungs-GmbH · Ernst Müller-Str. 7 · 8201 Schaffhausen · Schweiz
Telefon +41 (52) / 644 30 00 · Telefax +41 (52) / 644 30 60 · info@marquardt.ch · www.marquardt.ch