

LIN-BUS ROCKER SWITCH

SERIES 3270



RELIABLE AND FLEXIBLE: MARQUARDT LIN-BUS ROCKER SWITCH 3270 FOR OFF-ROAD VEHICLES

Off-road vehicles have to prove their functional ability under extreme conditions. Drivers expect absolute reliability and user-friendliness from the components and modules used. Due to its high level of dust and water protection, the LIN BUS rocker switch makes an essential contribution to this. In addition, an integrated LIN-BUS controller enables a network of up to 16 participants. Thus, it offers an extremely high degree of individualization for users.

FEATURES

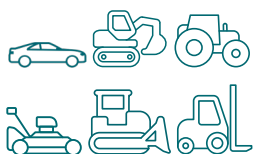

- Single rocker switch with integrated LIN-bus controller and interface
- LIN switch bus network with up to 16 participants
- Different rocker designs, colors and symbols
- White, dimmable symbol illumination with brightness adjustable via PWM
- Dimmable RGB function illumination with brightness adjustable via PWM
- Dust and water protection IP 69K front and IP 54 terminal side
- Mounting compatible with hard-wired switch series 3250

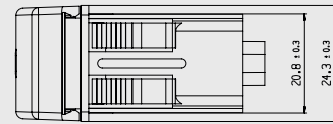
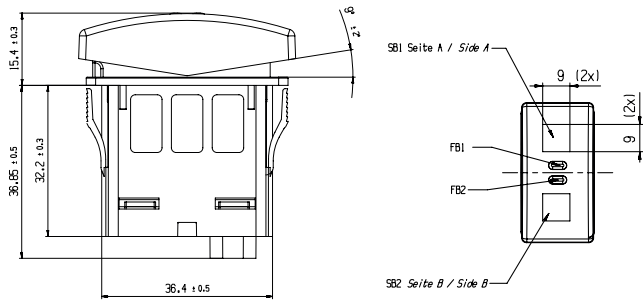

Elektrischer Anschluss
Electric connection

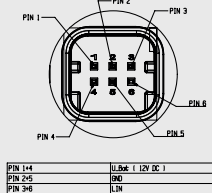

Stecker
Connector



6 polig NanoMQS, Buchsengehäuse
TE Teilenummer: 2112593-1 Codierung A
6 pos. NanoMQS Socket Housing
TE Part Number: 2112593-1 Coding A

6 polig NanoMQS, Buchsengehäuse
TE Teilenummer: 2112594-1 Codierung A
6 pos. NanoMQS Socket Housing
TE Part Number: 2112594-1 Coding A

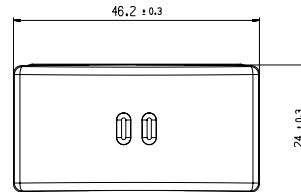

Cut-out wall thickness

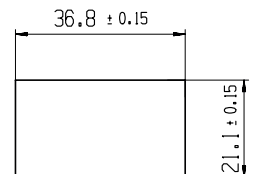

TECHNICAL INFORMATION

Main features

- LIN signal looped through via „Daisy Chain“
- For 12 V DC applications
- 2 3-wire bus with Ubatt, LIN, GND
- 2 Speed 19.2 kbit/s
- Durable surfaces
- Cap with laser engraved symbols (max. 9 x 9 mm)

Power consumption

- Operation mode ~30-50 mA at 12 V DC (depending on number of active LEDs)
- Sleep mode <0.1 mA at 12 V DC

Life endurance

100,000 actuations (ON) – OFF – (ON)

Switching functions

OFF – ON* OFF – (ON)*
ON – OFF – ON* (ON) – OFF – (ON)
(ON) – OFF – ON*

Connector type

TE 6-pin NANO MQS 2112593-1 A and 2112594-1 A
Pinning: 1+4 Ubatt – 2+5 GND – 3+6 LIN

Protection type

IP 69K (front) and IP 54 (terminal side)

Detailed specifications are available on request

RELATED PRODUCTS



ROCKER SWITCH
Series 3250



INTELLI MODULE KEYPAD
Series 3362



CENTRAL CONTROL UNIT
Series 3583

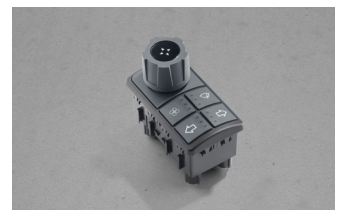

INTELLI JOG MODULE
Series 3362

ALWAYS IN TOUCH WITH MARQUARDT

As a mechatronics expert we connect human and machine with intelligent, electromechanical and electronic systems and components worldwide. Global leading brands from the automotive, electronics and power tool industries rely on Marquardt's expertise for over 95 years.

www.marquardt.com
Marquardt GmbH
Schloss-Straße 16
78604 Rietheim-Weilheim
Germany

Check our website for your
personal sales contact.

get in contact



© Marquardt 10/2022