

# KEYPAD MODULE

SERIES 3362



6 Button Keypad with Indicators

## MARQUARDT INTELLI CONTROL MODULES - FOR SAFER AND MORE INTUITIVE OPERATION UNDER ANY CONDITION.

Introducing the Marquardt family of Intelli-Control Modules. A compact, CAN-enabled, modular platform with a highly configurable, differentiated and brand-defining operator experience, to drive the future of off-road vehicles.

### FEATURES



- Marquardt automotive expertise for superior haptics in the harshest environments
- Ergonomic design for easy location and optimized “blind” / intuitive operation
- First-class feel / high-quality haptics
- Great functionality within a small package size

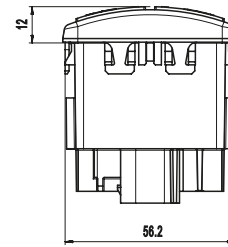
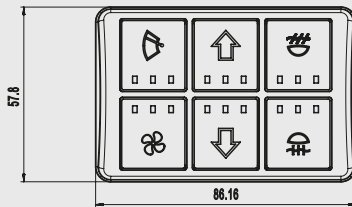
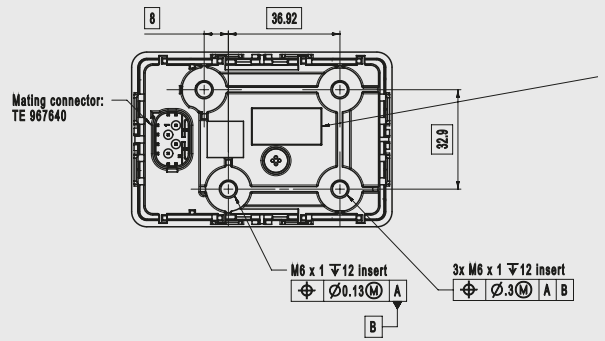
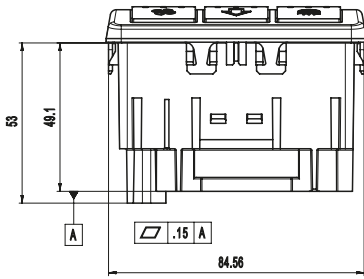

## TECHNICAL INFORMATION

Operating Voltage:	7.6 to 32 V DC
Supply Voltage:	12 / 24 V DC
Communication:	CAN bus J1939
Baud Rate (kbps):	250 / 500
IP Rating:	66K / 67
Length (mm) x Width (mm) x Mounting Depth (mm):	86 x 58 x 53
Keypad Buttons:	6
Symbol Illumination:	Backlit momentary push buttons
Function Illumination:	Up to 3 indicators
Operating Temperature:	-40 °C to 85 °C
Mounting Style:	4 threaded bushings (M6)

## RELATED PRODUCTS



**JOG MODULE**  
Series 3362



**ROTARY MODULE**  
Series 3362



**CENTRAL CONTROL UNIT**  
Series 3583

## ALWAYS IN TOUCH WITH MARQUARDT

As a mechatronics expert we connect human and machine with intelligent, electromechanical and electronic systems and components worldwide. Global leading brands from the automotive, electronics and power tool industries rely on Marquardt's expertise for over 95 years.

www.marquardt.com  
Marquardt GmbH  
Schloss-Straße 16  
78604 Riethem-Weilheim  
Germany

Check our website for your  
personal Sales contact.

get in contact

  
**MARQUARDT**

© Marquardt 09/2021